

# MANUAL

## ADJUSTABLE LANYARDS



ELSF-LAR-SNAP, LAR-EASY, LAR-MGO

### NOTIFIED BODY FOR EU TYPE EXAMINATION AND PRODUCTION CONTROL:

Apave Exploitation France SAS (0082) 6 Rue du General Audran - 92412 COURBEVOIE cedex - France.

The work positioning lanyard is classed as a personal protective Equipment(PPE) by the European Regulation 2016/425 and has been shown to comply with this through the European Standard EN358:2018.

### PERFORMANCE AND LIMITATIONS

Work positioning device LAR is a component of fall protection equipment compliant with EN 358: Personal protective equipment for work positioning and prevention of falls from a height. Belts and lanyards for work positioning or restraint. The device is used to prevent a free fall of the user by connecting a body holding device to an anchor point or to a structure by encircling it and supporting the user in tension.

The device is designed for protection of one person of max. weight 140 kg.

Work positioning device LAR shall not be used as a fall arrest device. If there is a risk of a fall from height, always use additional fall arresting device in accordance with EN 363. Work positioning device LAR can be fitted only with certified connectors compliant with EN 362.

### WARNING:

Two separate lanyards each with an energy absorber should not be used side by side. The temperature, burr, chemical, electricity, cuts, scratch, UV, knots in the lanyard and, surface abrasion and other moisture would effect on limitation of materials in the product or hazard which may affect its performance.

Knots are not recommended for lanyard because they affect performance. The lanyard can't be used choke hitched.

The total length of a lanyard connected to an energy absorber (including terminations and connectors) shall not exceed 2m.

When the lanyard is used for fall arrest, the energy absorber should be connected and a full body harness is the only acceptable body holding device that can be used in a fall arrest system, connector can be connected only to full body harness fastening points marked with the capital "A".

Avoid using in extremes of temperature, trailing or looping of lanyards of lifelines over sharp edges, chemical reagents, cutting, abrasion, climatic exposure & pendulum falls.

### INSTALLATION

1. Attach connector for rope length adjuster to one side attachment buckle of a work positioning belt compliant with EN 358. Put the rope around a construction element and attach the connector to the other side attachment buckle – Fig. 1. Construction element should be located at the height of user's waist or above. Shape and construction of construction element shall not allow for a self-acting disconnection of the device. Minimal static strength of the element should be 12kN. Rope of the device should be protected with protective sleeve to prevent damage of the rope when in contact with abrasive surface or sharp edges of the element around which it is routed – Fig. 1a).
2. The device can be attached to attachment buckle of a sit harness compliant with EN 813 or a single D-ring of a work positioning belt – Fig. 2. Attach connector for rope length adjuster to attachment buckle of a harness, and rope connector to anchor point located at the height of user's waist or above. Shape and construction of anchor point must not allow for a self-acting disconnection of the device. Minimal static strength of anchor point should be 12kN.
3. Lengthening the rope Unlock the adjuster by pressing adjuster lever – Fig. 3. Deflect from the construction to tension and lengthen the rope. Release the lever to lock of the rope and stop its lengthening. b) Shortening the rope Pull the rope free end towards the construction by inclining in this direction – Fig. 4

### NOTE:

Before and during operation, check whether individual attachment elements are connected properly. Connectors must be closed and protected against accidental opening by locking gear.

### NOMENCLATURE OF PARTS

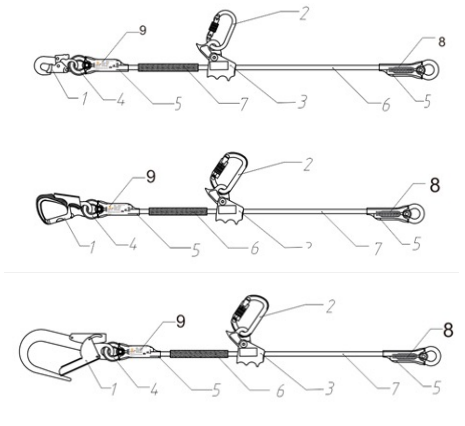

- |                           |                              |
|---------------------------|------------------------------|
| 1. Hook (SNAP, EASY, MGO) | 5. Plastic protection sleeve |
| 2. Carabiner              | 6. Rope                      |
| 3. Rope adjuster          | 7. Rope protection           |
| 4. Loop and Thimble       | 8. Stitching                 |



Type: WORK POSITION LANYARD  
 Model: LAR-SNAP-02  
 Mfg. date: 03/2024  
 Max. Length: 2M  
 Serial No.: 24030001



### MARKING

1. The CE mark showing that the product meets the requirements of the Regulation 2016/425
2. Identification of the manufacturer
3. Type of product name
4. products model number
5. Date of manufacture((Month{MM} and {Year}YYYY))
6. Batch number of the products
7. Serial No. of the products
8. The length of lanyard
9. Means "Always read and follow the warnings and instructions for use"
10. Company brand

